

- Slide a thin blade putty knife between deco ring and glass to loosen silicone.
- With a rubber mallet or a block of wood and a hammer, tap deco ring clip sideways until you see end of deco ring.
- Remove deco ring from frame by carefully spreading the two ends apart. Be careful not to damage the deco ring by over flexing the corners. The deco ring will be re-installed later
- Cut the silicone loose from the aluminum frame completely around the frame.
 - Cut down just past the gasket approximately a half of an inch in depth.
 - Remove the glass and gasket.

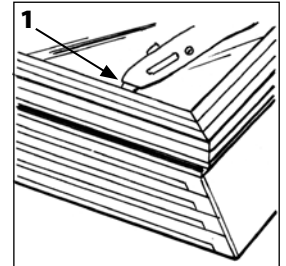

- Replacing Wood Frame (Skip if the wood frame is not being replaced.)
 - Lift wood out of the aluminum frame and clean aluminum to be free of debris.
 - Insert new wood frame into the aluminum frame.
 - Make sure the mylar tape (clear tape) is facing up and at the bottom side of the skylight.

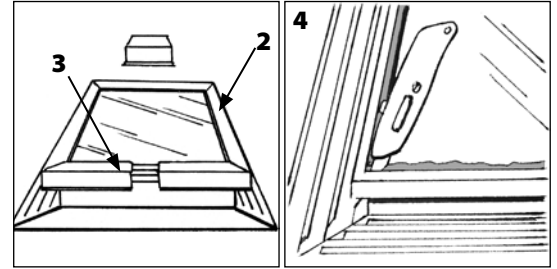

- Remove any silicone left on the frame and clean with alcohol. Also clean the edge of the replacement glass unit.

7. Installing Gasket

- Install gasket with the wick at the bottom side of the skylight.
- Thread the wick through the hole just above the wood and tie a knot.
- Thread the other end of the wick through the second hole and pull until snug.
- Tie a second knot as close to the frame as possible and cut off any extra wick.

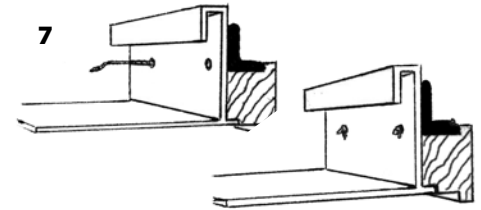

8. Install glass in frame carefully lowering the glass unit onto gasket.

- Make sure glass is seated in gasket as shown.
- Tinted glass faces the sun

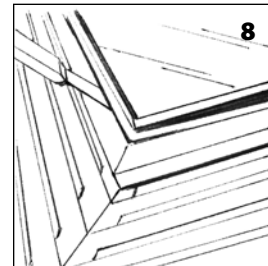

9. Sealing the Glass Unit into the Frame.

- Apply primer to all areas that will come into contact with silicone (cavity between glass and frame) and let dry.
- Apply silicone around skylight in the cavity between aluminum frame, glass and gasket. (Be sure that any air bubbles are removed by placing a nail into bubble and wiggle it around. Then add more silicone to the area.

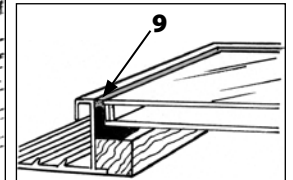

10. Carefully replace the deco ring around the aluminum frame. (Be sure the deco ring ledge engages the bottom of the frame).

- Replace the deco ring clip by placing the bottom of clip over the deco ring at gap and rotate it over the deco ring. (You may need to tap the deco ring clip down on the deco ring using a mallet or a block of wood and a hammer, do not strike the glass or it will break).

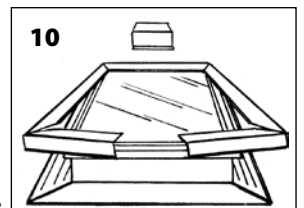
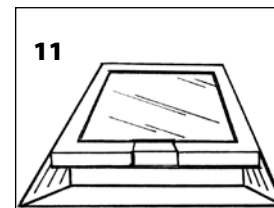

11. Completing Installation

- When completed, carefully remove any excess silicone from frame or deco ring with alcohol.
- Do not disturb deco ring or clip until the silicone has cured (approx. 24 hours).

KIT INCLUDES:

- Replacement Glass
- Gasket
- Silicone
- Primer
- Wick
- Brush

TOOLS NECESSARY:

- Putty Knife
- Utility Knife
- Pliers
- Caulking Gun
- Rubber Mallet
- Scraper
- Glass Cleaner
- Rags
- Brush ½"